

Meander Corner
Section 32-2-17
(N. 218,715.05)
(E. 2,402,991.69)

recorded as Chord=(N59°33'11"E 900.65')
recorded as Radius=(2864.93')
recorded as Arc=(904.40')
Northerly Line of Lot 3 of Certified Survey Map No. 833.
(Centerline of Former Chicago & Northwestern Railroad R.O.W.)

North line of the Southeast 1/4 of Section 32-2-17

Overhead Wires

Lot 3

C. S. M. 833

Proposed
Lease Area
0.375 Acre
16,341 Sq.Ft.

Found pipe down
1' & leaving 0.48'
N43°50'44"E of
corner, set new
pipe at surface.

Patio
Area
Around
Pool

Tax Parcel
JA 83300003A3

Lot 3

Interlaken Drive (60' Wide)

Walk

Culvert

Notes:

- 1) This Plat of Survey is not certified unless signed and sealed in red ink.
- 2) This survey is subject to Wisconsin Lien Law. This Plat of Survey is the notice of intent to file lien. Lien waiver required.
- 3) The Survey Date shown on this Plat of Survey is the completion date of the field work.

97

recorded in Vol. 4 of Certified Survey Maps of Walworth County on Page 9 and located in Government Lot 4 in the Southeast 1/4 of Section 32, Town 2 North, Range 17 East, Town of Geneva, Walworth County, Wisconsin.

Part of Lot 3 of Certified Survey Map No. 833, recorded in Vol. 4 of Certified Survey Maps of Walworth County on Page 9 and located in Government Lot 4 in the Southeast 1/4 of Section 32, Town 2 North, Range 17 East, Town of Geneva, Walworth County, Wisconsin, described as follows: Commencing at the East 1/4 corner of said Section 32; thence South 54°28'06" West 1833.32 feet to an iron pipe and the Point of Beginning; thence South 23°56'21" East 45.39 feet to an iron pipe; thence South 2°16'00" West 40.95 feet to an iron pipe; thence South 23°56'21" East 73.95 feet to an iron pipe on the Northernly line of Interlaken Drive; thence South 66°00'00" West, along said Northernly line, 100.43 feet to an iron pipe; thence South 73°00'00" West, along said Northernly line, 18.00 feet; thence North 15°40'00" West 87.97 feet to a point of curvature; thence Northernly along the arc of a curve to the right (Radius=65.29 feet, chord bears North 20°05'00" East 76.29 feet) 81.48 feet; thence North 55°50'00" East 66.92 feet; thence Northernly along the arc of a curve to the left (Radius=2929.93 feet, chord bears North 63°31'44" East 4.84 feet) 4.84 feet to the Point of Beginning.

101 Evergreen Parkway #3
Elkhorn, Wisconsin. 53121

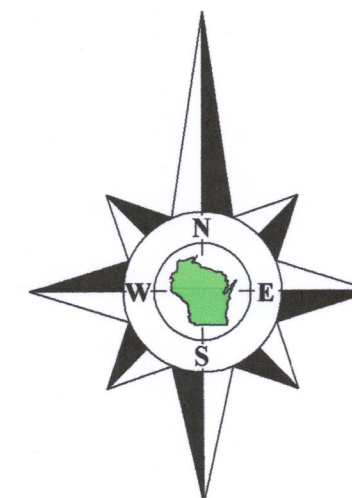

Bearings referenced to the South line of Interlaken Drive, recorded as N73°00'00"E on Certified Survey Map No. 833, which produces a bearing of S88°33'56"W on the North line of the Southeast 1/4 of Section 32-2-17. A rotation of -0°35'38" from the Wisconsin State Plane Coordinate System, South Zone, (NAD-27).

Coordinates are referenced to the Wisconsin State Plane Coordinate System, South Zone, (NAD-27)

C. S. M. 833

C. S. M. 8 3 3

**Proposed
Lease Area**
0.375 Acre
16,341 Sq.Ft.

Tax Parcel
JA 83300003A3

Lot 3

50
records

(Private Road)

Interlaken Drive

(60' Wide)

C. S. M. 833

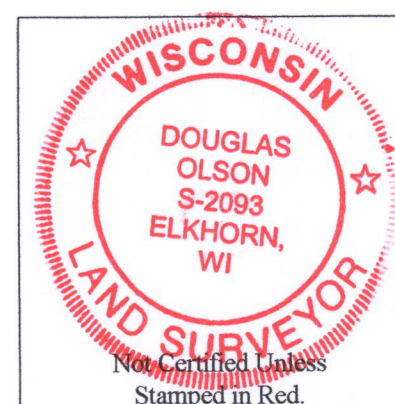

- 1) This Plat of Survey is not certified unless signed and sealed in red ink.
- 2) This survey is subject to Wisconsin lien laws. This Plat of Survey is the notice of intent to file lien. Lien waiver required.
- 3) The Survey Date shown on this Plat of Survey is the completion date of the field work.

All rights reserved. No part of this survey plat may be reproduced or transmitted in any form by any means - graphic, electronic, or mechanical, including photocopying, tracing, or information storage and retrieval systems - without permission in writing from Douglas G. Olson, Olson Land Surveying, LLC.

This survey is made for the exclusive use of the present owners of the property, and also those who purchase, mortgage or guarantee title thereto, within one year from the date hereof.

Douglas G. Olson
Wisconsin Professional Land Surveyor - 2093

Survey Date: November 5, 2018.

Revisions:

Scale in Feet

45 South Wisconsin Street | P.O. Box 322
Elkhorn, Wisconsin, 53121
Telephone: (262) 723-3434
Facsimile: (262) 723-8044
Email: doug@olsonsurveying.com
Website: www.olsonsurveying.com



OLSON
LAND SURVEYING, LLC

Rural | Residential | Commercial

Legend of Symbols & Abbreviations		N	North
Found County Section Corner		S	South
Set Iron Pipe		W	West
Set Iron Pipe, 1" dia.		E	East
Recorded Information			In Bearings
Utility Pole			o Degrees
Utility Pedestal			" Minutes
Manhole			" Seconds
Lamp			In Distances
Asphalt Surface			" Feet
Concrete			" Inches

Sheet 1 of 1 Sheets

Drawing Name:

Job Reference Number
2018.079

2018.079